

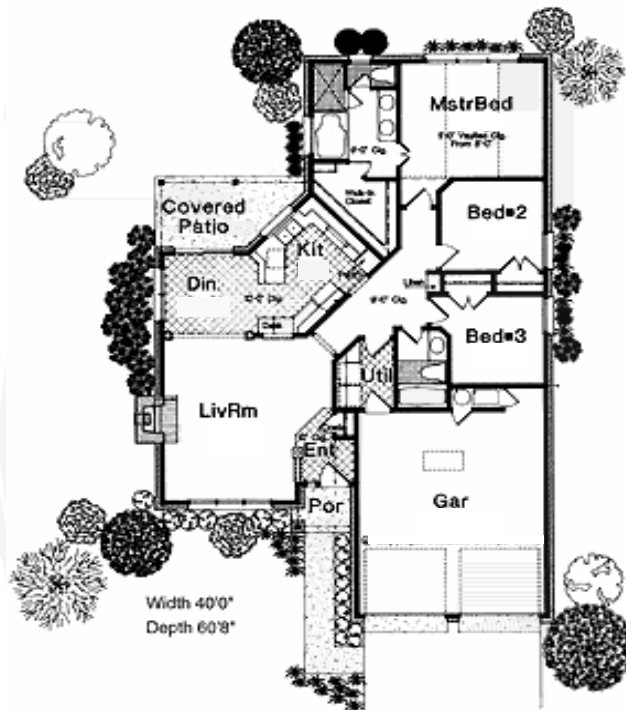

# MAGNOLIA RIDGE

**Rothwell Builders, Inc.**



- One Story Living
- Open/Vaulted Areas
- Handicap Accessible
- Gas Fireplaces
- Architecturally Designed Kitchen/Eating Areas
- 3 Bedrooms, 2 Bathrooms
- Master Suite Features Whirlpool Tub, Double Vanity, Separate Shower
- Two Car Attached Garage
- Optional Maintenance Plan
- Within Walking Distance to Heritage Hill Park and Swimming Pool

⇒ Actual Elevations and Room Sizes May Vary—Consult Blueprints for Accurate Dimensions

P.O. Box 384  
Irwin, PA 15642

Phone: 412-298-6452  
Fax: 724-864-5085  
Email: [RothwellBldr@aol.com](mailto:RothwellBldr@aol.com)



**A Harrison  
Development Project**

**Experience Southern Living in White Oak Boro**