

MAGNOLIA RIDGE

Rothwell Builders, Inc.

Lot #2 Package

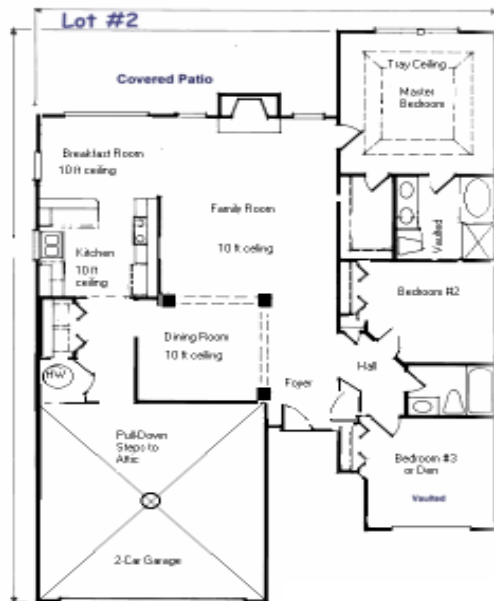

- One Story Living
- Open/Vaulted Areas, plant ledges, recessed lighting
- Handicap Accessible
- Gas Fireplaces
- Architecturally Designed & Equipped Kitchen
- Separate Laundry Facility
- 3 Bedrooms, 2 Bathrooms
- Master Suite Features Whirlpool Tub, Double Vanity, Separate Shower
- Two Car Attached Garage
- Home Package includes concrete driveway & turn-around, rear patio, walkways and complete landscaping
- Optional Maintenance Plan can be arranged
- Within Walking Distance to Heritage Hill Park and Swimming Pool

P.O. Box 384
Irwin, PA 15642

Phone: 412-298-6452
Fax: 724-864-5085

Email:
RothwellBldr@aol.com



A Harrison
Development Project

Experience Southern-Style Living in White Oak Borough